

Exetel SOHO (Small Office Home Office) Business Packages

Exetel offers a selection of small business packages which will suit the small office, home office (SOHO) market. The small business solutions range from 1 up to 6 employees. If your business requires only a basic but reliable data connection and traditional phone, Exetel can cater for it. As it expands or if a solution is required for a more established small business, Exetel can also cater to this requirement.

Small Business Package 1 (B31)

This package includes an ADSL2+ data connection, with a traditional landline telephone service (POTS).

Benefits

- Unlimited ADSL2+ speed (up to 20 Mbps downstream, 1 Mbps upstream).
- Traditional telephone service (POTS) using an existing analogue telephone handset.
- FREE local, national and calls to Optus mobiles.
- Simple to connect and commence using.

B31
Small Business
\$49 /month
Unlimited ADSL2+ + Free Local, National and calls to Optus Mobiles

Costs

- \$0.00 - No Installation Fee
- BYO ADSL Modem

NB16WV modem/VoIP Gateway

The connection diagrams refer to this NBN/Fibre ready Netcomm Modem:



:

Recommended Solution (NB16WV modem shown but you can BYO)

- Connect ADSL2+ + phone (with filter) to the ADSL port.
- Make traditional phone calls over plain old telephone system (POTS).
- Computers connect to the Ethernet (LAN) ports.
- Computers can connect wirelessly to the in-built Wi-Fi (remote computers also require Wi-Fi).

Connection Diagram

This diagram below depicts the NBN ready NB16WV Modem; however you can use your existing ADSL Modem.

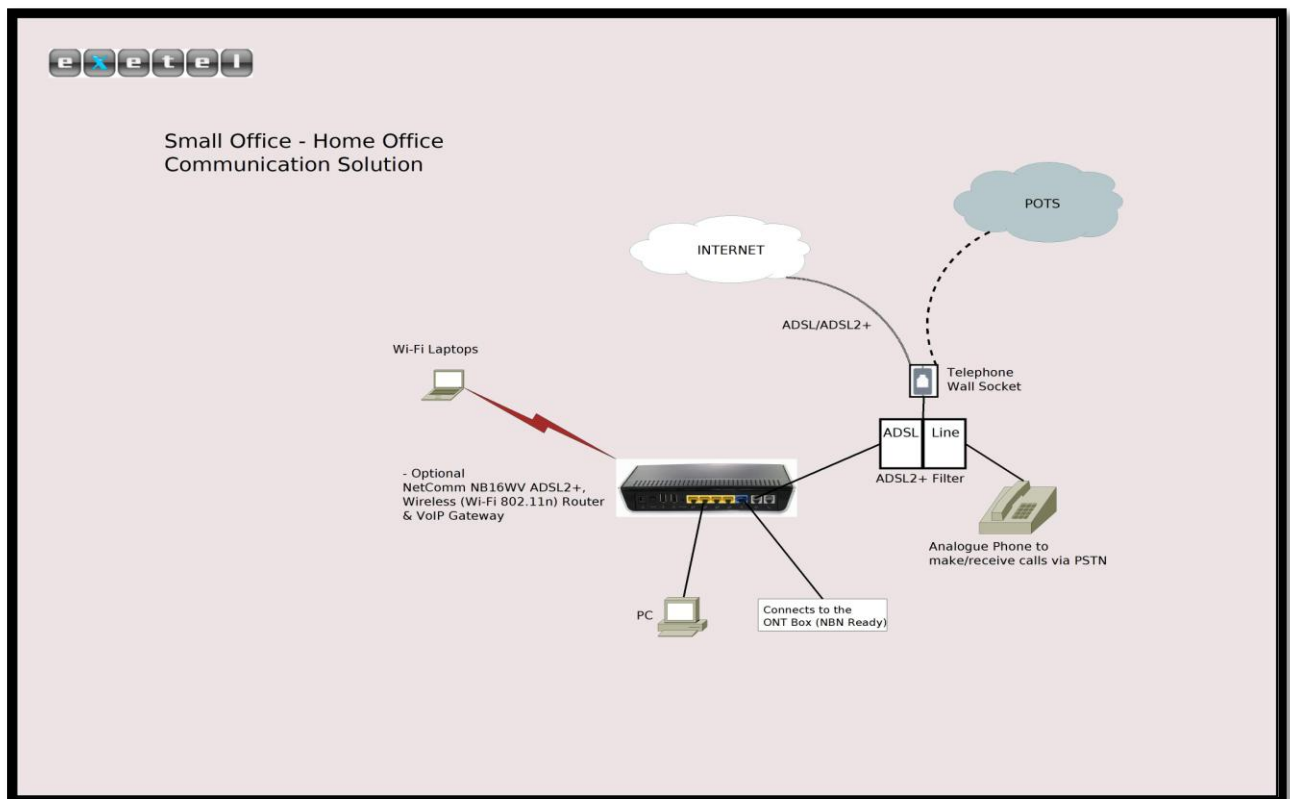

Small Business Package 2 (B33)

This package not only includes an ADSL2+ data connection, with a traditional landline (PSTN) telephone service but also a state-of-the-art Netcomm Modem which is **NBN ready** and gives you the peace of mind of having a backup mobile broadband service, with automatic fail-over, which ensures an always on Internet connection.

Benefits

- ADSL2+ speed (up to 20 Mbps downstream, 1 Mbps upstream).
- Traditional telephone service (POTS) using an existing analogue telephone handset.
- FREE local, national and calls to Optus mobiles.
- Provision for an analogue handset to connect to a VoIP port allowing another (VoIP) phone line.
- Netcomm NB16WV Modem and VoIP Gateway which is NBN ready.
- Mobile Broadband USB modem INCLUDING backup data.

B33

**Small or Home Office
(with 1 or 2 employees)**

\$59 /month

Unlimited ADSL2+
+
**Free Local, National and calls to
Optus Mobiles**
+
**Mobile Broadband service
providing 'failsafe' backup**

Costs

- \$139.00 Installation fee (includes a FREE NB16WV Modem and USB modem with 1GB of mobile broadband data).

Recommended Solution

- Connect ADSL2 + phone (with filter) to the ADSL port.
- Make traditional phone calls over plain old telephone system (POTS) using a typical analogue handset.
- Computers connect to the Ethernet (LAN) ports.
- Computers can connect wirelessly to the in-built Wi-Fi (remote computers also require Wi-Fi).
- Mobile broadband backup service connects via USB modem inserted in the USB 3G port.

Connection Diagram

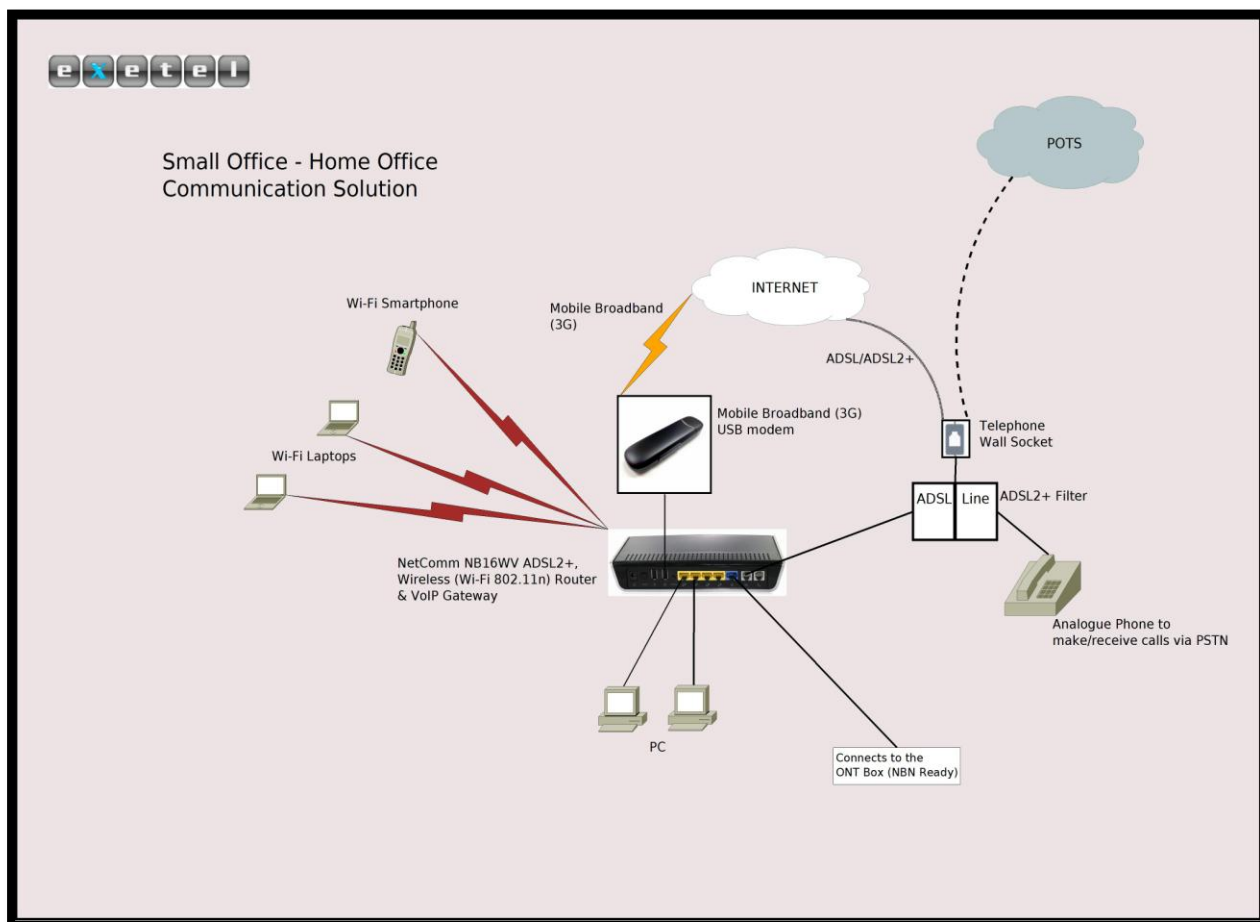

Small Business Package 3 (B35)

This package includes the entire B33 package with the ability to connect multiple phone devices and the inclusion of making calls over the internet (VoIP – Voice over IP)

Benefits

- ADSL2+ speed (up to 20 Mbps downstream, 1 Mbps upstream).
- Traditional telephone service (POTS) using an existing analogue telephone handset.
- FREE local, national and calls to Optus mobiles.
- Provision for an analogue handset to connect to a VoIP port allowing another (VoIP) phone line.
- Netcomm NB16WV Modem and VoIP Gateway which is NBN ready.
- Mobile broadband USB modem INCLUDING backup data.
- The BV20 Exetel VoIP plan which has 80 included local and national calls as well as 120 minutes of calls to mobiles.
- Up to 6 DIDs (VoIP numbers) included.

B35

**Small or Home Office with VoIP
(with up to 6 employees)**

\$79 /month

Unlimited ADSL2+
 +
**Free Local, National and calls to
Optus Mobiles**
 +
**Mobile Broadband service
providing 'failsafe' backup**
 +
**VoIP Plan which can
accommodate up to 6 employees**

Details of the BV20 Business VoIP Plan (included in the B35 Plan)

Plan	Monthly Plan Charge	Included local/national calls	Included minutes to Mobiles	Total Included Value
BV20	\$20.00	80 calls	120 minutes	over \$25.00

Costs

- \$139.00 Installation fee (includes a FREE NB16WV Modem and USB modem with 1GB of mobile broadband data).
- Optional \$179.00 A510IP Gigaset IP phone and unit (can be purchased from the hardware store).
- Optional \$79.00 additional A510H Gigaset handsets (depending on no. of employees).

Recommended Solution

- Connect ADSL2 + phone (with filter) to the ADSL port.
- Make traditional phone calls over telephone system (POTS) using a typical analogue handset.
- Computers connect to the Ethernet (LAN) ports.
- Computers can connect wirelessly to the in-built Wi-Fi (remote computers also require Wi-Fi).
- Mobile broadband backup service connects via USB modem inserted in the USB 3G port.
- Connect any IP enabled telephone handset (Cisco SPA502G shown) to the FXS port and make calls over VoIP (DID required).
- *Optional service for larger businesses* - Connect A510P Gigaset IP handset and unit to the Ethernet port and make calls over VoIP (DID required).
- *Optional service for larger businesses* - Any additional A510H Gigaset wireless IP handsets connect to the A510P Gigaset unit (DIDs required).

Connection Diagram

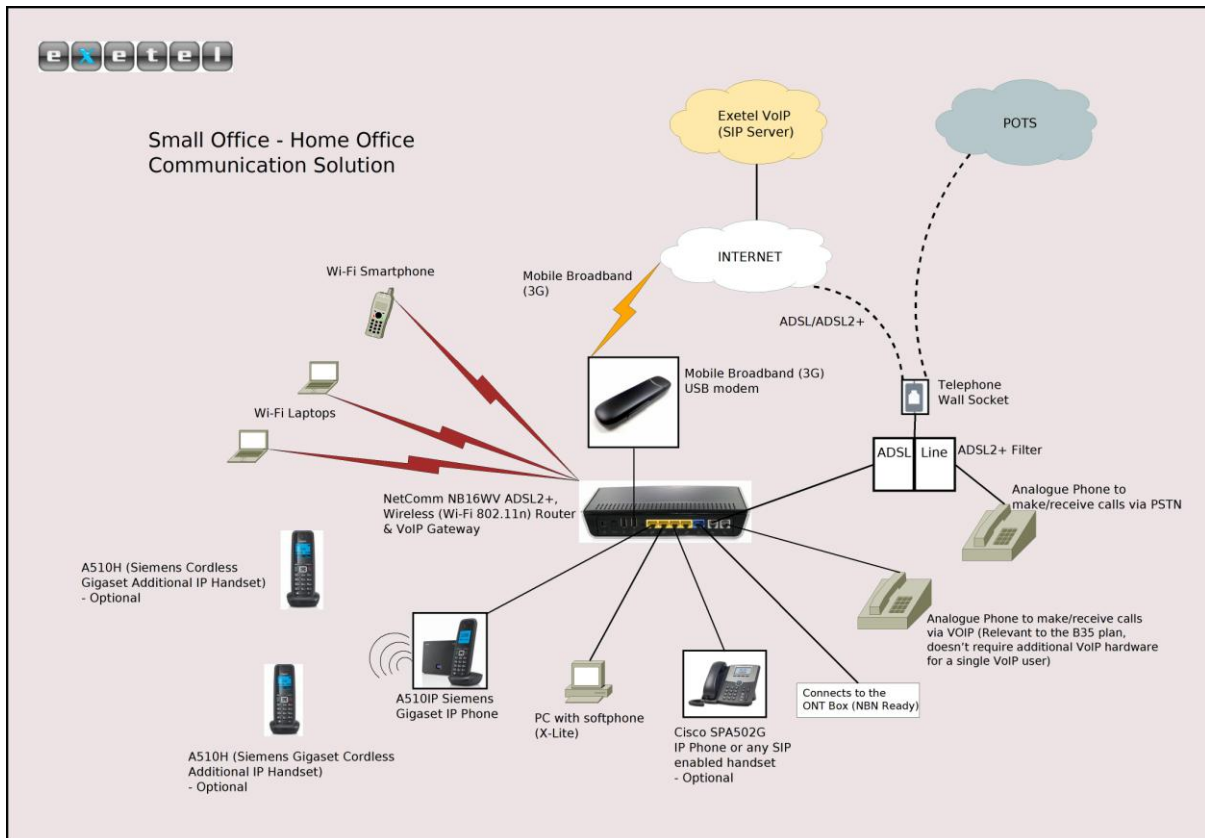

Porting Charges

For customers wishing to port their local PSTN numbers Exotel VoIP service numbers, these are the charges:

LNP (Local Number Portability) Range	Once-off Charge
1 Number (CAT-A) simple port - PSTN	\$15.00

Provisioning time frame is 10 business days for a simple PSTN-CAT A port.

Hardware



A510IP Gigaset IP Phone and Unit (\$179.00)



A510H Gigaset Additional IP Handset (\$79.00 per additional handset)



Cisco SPA 502G (\$165.00)

For current selection of hardware available, please refer to:
<https://www.exetel.com.au/modemorder/index.php> under VoIP products.

For further details and to order please contact one of our dedicated Small Business Account Managers on:

1300 EXE TEL (1300 393 835) – Select Option 2

or email

smallbusiness@exetel.com.au

